

Key No.	Part Description
1	Body
2	Stem
3	Stem Disc (Soft Seat)
4	Packing, Dyna-Pak®
5	Packing Nut
6	Panel Mounting Nut
7	Handle
8	Hex Nut

3700 – 3800 Series Valves

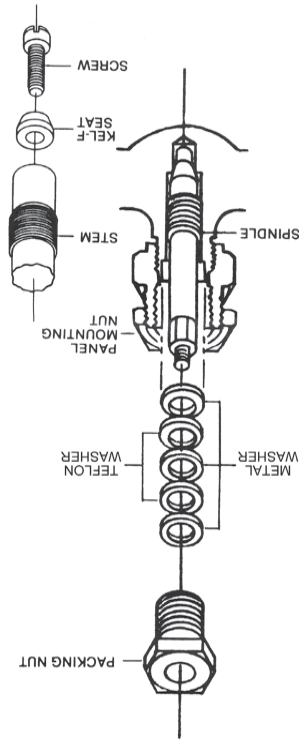
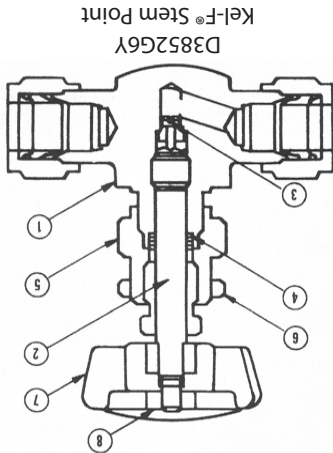

1. On soft seated valves, replace Kel-F® seat if required. Apply Loctite® 262 to screw threads and torque to 4 inch lbs.
2. Thread lubricated spindle into housing making sure it is not seated.
3. Insert packing as illustrated. See exploded view.
4. Screw packing nut on body and torque to 100 inch lbs.
5. Assemble handle to valve and torque hex nut to 15 inch lbs.
6. Insert plug button.

Assembly

1. Lubricate spindle threads, body threads and Teflon® washers with Krytox 206. NOTE: Use above lubricant or equivalent fluorocarbon oil.

Lubrication

1. Lift out plug button, being careful not to bend spring clips, unscrew hex nut and remove hand wheel.
2. Unscrew packing nut and extract packing from housing.
3. If valve is soft seated (and stem tip is to be replaced) remove spindle. Remove screw and discard Kel-F® seat.
4. Thoroughly clean packing surfaces with acetone.

Disassembly

3700 – 3800 Series Valves

FOR USE WITH MODEL NUMBERS:

BRASS	303 S.S.	316 S.S.	BRASS	303 S.S.	316 S.S.
D3712F2B	D3712F2S	D3712F2Y	D3812F4B	D3812F4S	D3802L4Y
D3712G2B	D3712G4S	D3712G2Y	D3812G6B	D3812L4S	D3802L64Y
D3712G4B	D3712H4S	D3712G4Y	D3812G8B	D3852F4S	D3812F4Y
D3712H4B	D3712M2S	D3712H4Y	D3812M6B	D3852L4S	D3812G6Y
D3712M2B	D3712M4S	D3712M4Y	D3812L4B		D3812G8Y
D3712M4B	D3722M4S	D3722G4Y	D3852F4B		D3812M6Y
D3722F2B	03752F2S	D3722H4Y	D3852G6B		D3852F4Y
D3722H24B	D3752M4S	D3732M4Y	D3852M6B		D3852GW
D3722M2B		D3752F2Y	D3852G8B		D3852G8Y
D3722M4B		D3752G2Y	D3852L4B		D3852M6Y
D3732M2B		D3752G4Y			D3862L4Y
D3732M4B		D3752H4Y			D3862L64Y
D3752G2B		D3752M4Y			
D3752F2B		D3752M4Y1			
D3752G4B		D3752M4Y2			
D3752H4B					
03752M2B					
D3752M4B					



3700 & 3800 SERIES NEEDLE VALVES Packing & Seat Replacement Kit #SP3700K5

For catalog information, contact your local Hoke stocking distributor or call Hoke, Inc. at (864) 574-7966.



Hoke, Inc.
405 Centura Court, Spartanburg, SC 29303
www.hoke.com

Kit includes: Teflon® washers (2), metal washers (3), Kel-F® seat (1), and screw (1).

For Complete Listing of Model Numbers See Back Panel