

**MAXIMUM WORKING CONDITIONS**  
 COLD WORKING PRESSURE:  
 STANDARD, 6,000PSI (414BAR)  
 (AT REDUCED TEMPERATURE)

TEMPERATURE:  
 -29°C (-20.2°F) TO 240°C (464°F)  
 (AT REDUCED PRESSURE)

APPROX WEIGHT  
 0.6Kg

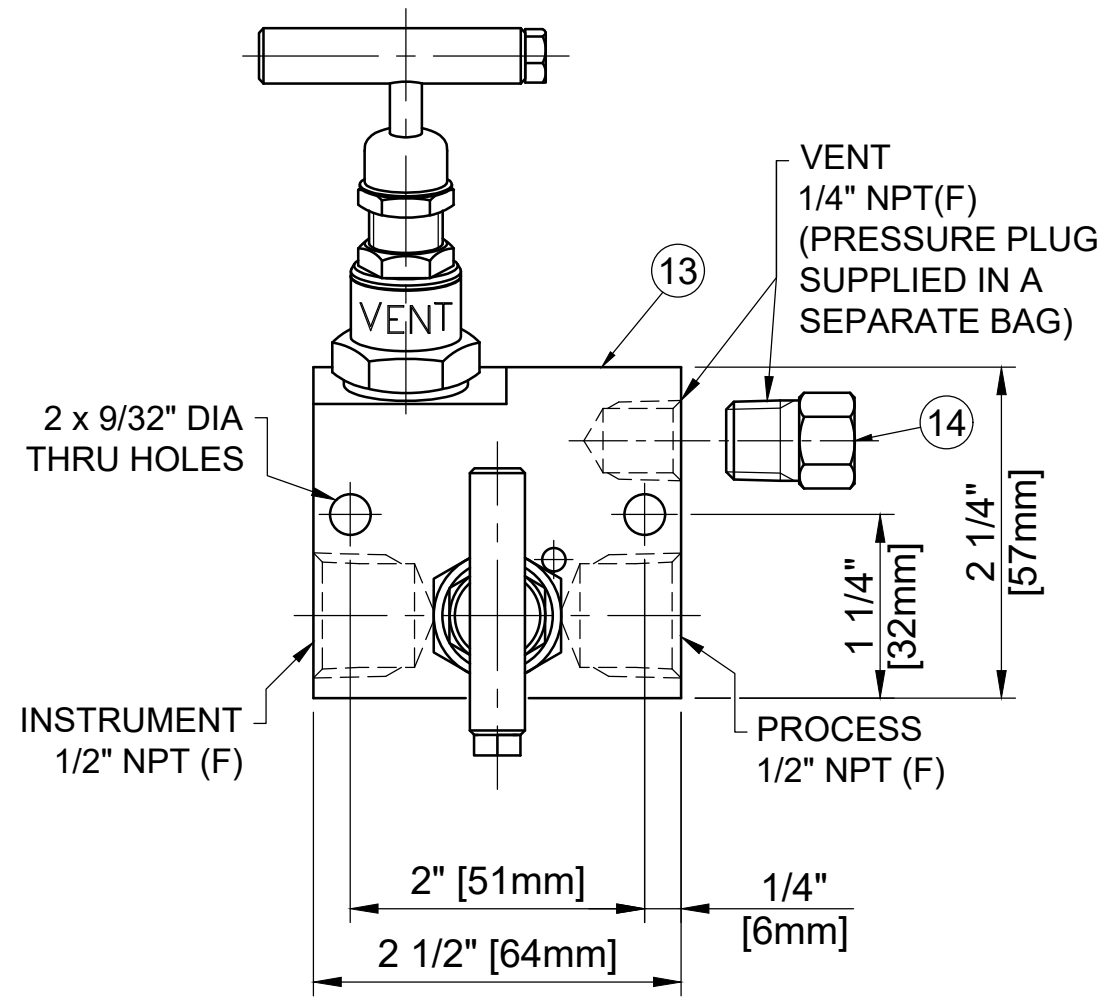
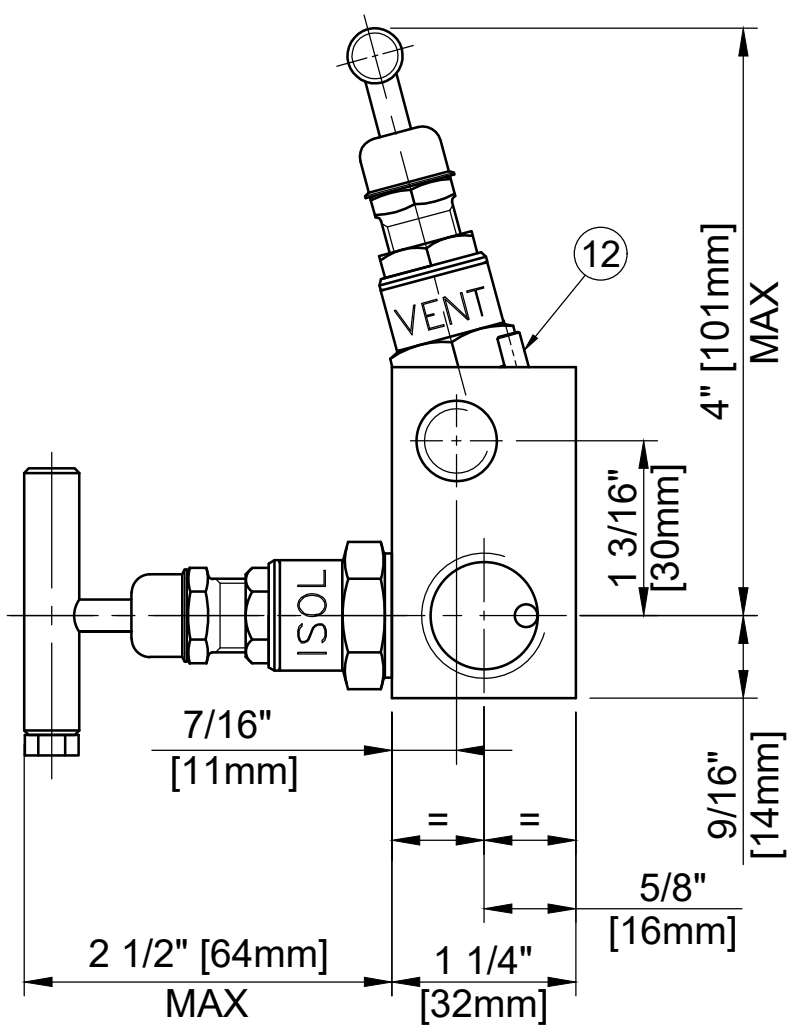

HEADUNIT DETAIL

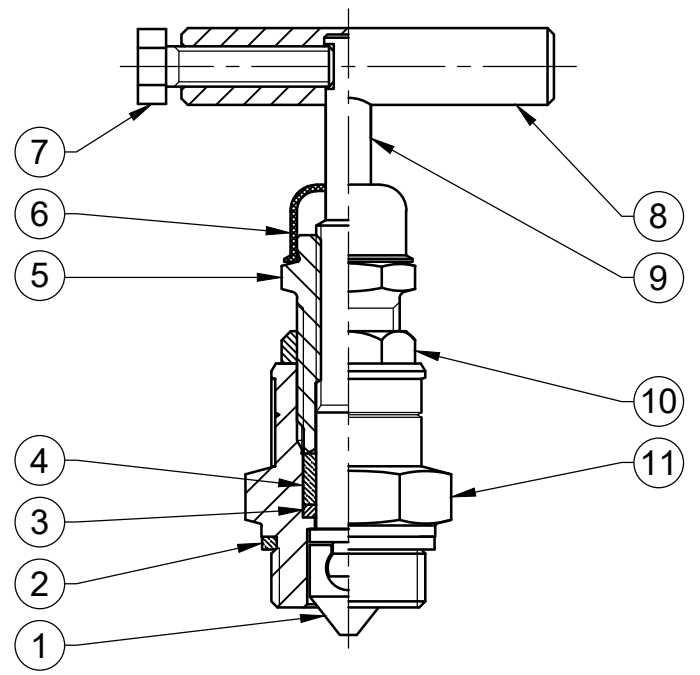

REF No	DESCRIPTION	MATERIAL
		TITANIUM
1	TIP	ASTM B348 GR5
2	BODY SEAL	100% VIRGIN PTFE
3	PISTON RING	ASTM B348 GR5
4	SEAL BUSH	100% VIRGIN PTFE
5	PUSHER	316 SS
6	DUST CAP	LOTREX 2300
7	SCREW	A4 [316] SS
8	TEE BAR	316 SS
9	SPINDLE	ASTM B348 GR5
10	LOCKNUT	316 SS
11	SEAL HOUSING	ASTM B348 GR5
12	LOCK PIN	316 SS
13	BODY	ASTM B348 GR5
14	PRESSURE PLUG	ASTM B348 GR5

MARKING DETAILS  
 (MARKING REFERENCE ONLY)



REMARK

- ADDITIONAL TAG PLATE FOR ADDITIONAL INFO UPON REQUESTED
- HCT HEAT CODE TRACEABILITY WILL BE MARKED ON BODY & END FITTINGS

THE INFORMATION CONTAINED IN THIS DRAWING IS THE PROPERTY OF CRANE COMPANY. ANY REPRODUCTION IN PART OR AS A WHOLE WITHOUT THE WRITTEN PERMISSION OF CRANE COMPANY IS PROHIBITED.

REMOVE ALL BURRS, DO NOT SCALE DRAWING, DRILL POINTS STD

BREAK CORNERS 0.005 - 0.010

UNLESS OTHERWISE SPECIFIED, DIMENSIONS ARE IN INCHES

TOLERANCES ARE:

.XXX + .005	ANGLES 1:1
.XX + .010	CENTRICITY 1:0.015
X + .060	MACHINE FINISH 63RMS

APPROVALS		DATE
CREATED	ZL	12/12/2023
DRAWN	ZL	12/12/2023
APPROVED	GT	14/12/2023

EC NUMBER X

INITIAL USAGE (REF ONLY) X

CAD FILE NAME

CRANE	HOKE
SPARTANBURG, SOUTH CAROLINA 29303	
TITLE GENERAL ARRANGEMENT TYPE G12AF 1/2" FEMALE x FEMALE GAUGE ISOLATE VALVE	
SIZE A3	PAGE CODE
SCALE N.T.S	XXXXX
DWG NO. A18781	REV B
SHEET 1 OF 1	