

MAXIMUM WORKING CONDITIONS
 COLD WORKING PRESSURE:
 HIGH PRESSURE, 10,000PSI (690BAR)
 (AT REDUCED TEMPERATURE)

TEMPERATURE:
 -29°C (-20.2°F) TO 240°C (464°F)
 (AT REDUCED PRESSURE)

APPROX WEIGHT
 1.0Kg

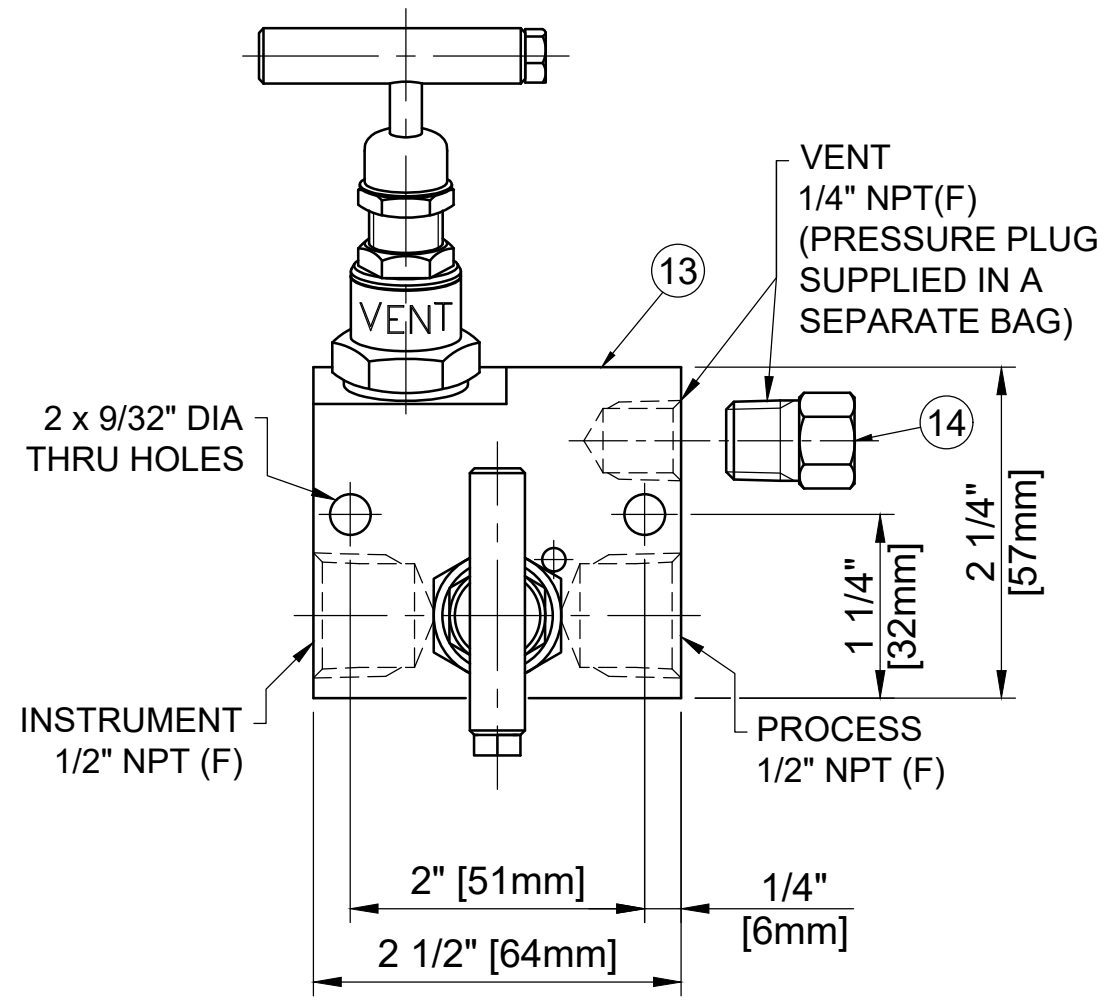
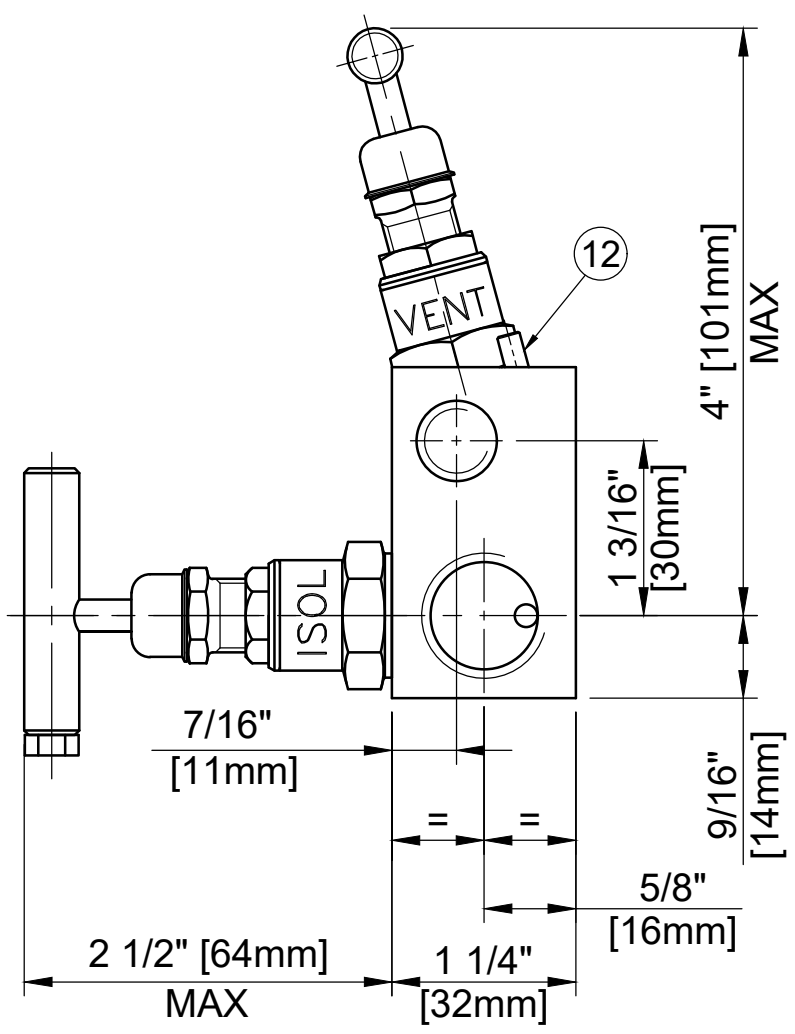

HEADUNIT DETAIL

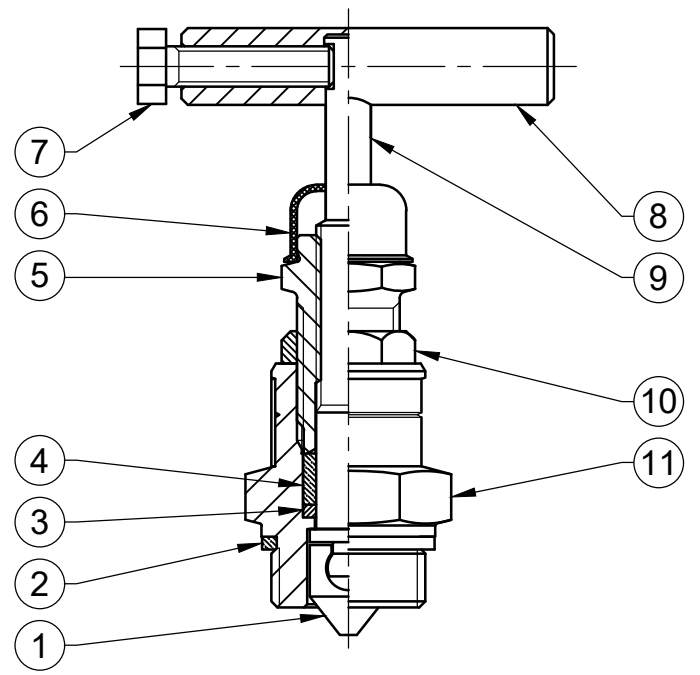

REF No	DESCRIPTION	MATERIAL
		STAINLESS
1	TIP	ASTM A276 /A479 316
2	BODY SEAL	100% VIRGIN PTFE
3	PISTON RING	316 SS
4	SEAL BUSH	100% VIRGIN PTFE
5	PUSHER	316 SS
6	DUST CAP	LOTREX 2300
7	SCREW	A4 [316] SS
8	TEE BAR	316 SS
9	SPINDLE	ASTM A276 /A479 316
10	LOCKNUT	316 SS
11	SEAL HOUSING	ASTM A276 /A479 316
12	LOCK PIN	316 SS
13	BODY	ASTM A276 /A479 316
14	PRESSURE PLUG	ASTM A276 /A479 316

MARKING DETAILS
 (MARKING REFERENCE ONLY)



REMARK

- ADDITIONAL TAG PLATE FOR ADDITIONAL INFO UPON REQUESTED
- HCT HEAT CODE TRACEABILITY WILL BE MARKED ON BODY & END FITTINGS

THE INFORMATION CONTAINED IN THIS DRAWING IS THE PROPERTY OF CRANE COMPANY. ANY REPRODUCTION IN PART OR AS A WHOLE WITHOUT THE WRITTEN PERMISSION OF CRANE COMPANY IS PROHIBITED.

APPROVALS	DATE	
CREATED ZL	12/12/2023	
DRAWN ZL	12/12/2023	TITLE GENERAL ARRANGEMENT TYPE G12AF 1/2" FEMALE x FEMALE GAUGE ISOLATE VALVE
APPROVED GT	14/12/2023	
BREAK CORNERS 0.005 - 0.010	UNLESS OTHERWISE SPECIFIED, DIMENSIONS ARE IN INCHES	SIZE A3 SCALE N.T.S. SHEET 1 OF 1
TOLERANCES ARE: .XXX + .005 ANGES .11" .XX + .010 CONCENTRICITY .0015 X + .060 MACHINE FINISH 63RMS		SPARTANBURG, SOUTH CAROLINA 29303 DWG NO. A18782 REV B