

**MAXIMUM WORKING CONDITIONS**  
**COLD WORKING PRESSURE:**  
 STANDARD, 6,000PSI (414BAR)  
 (AT REDUCED TEMPERATURE)  
  
**TEMPERATURE:**  
 -29°C (-20.2°F) TO 240°C (464°F)  
 (AT REDUCED PRESSURE)

**APPROX WEIGHT**  
 1.0Kg

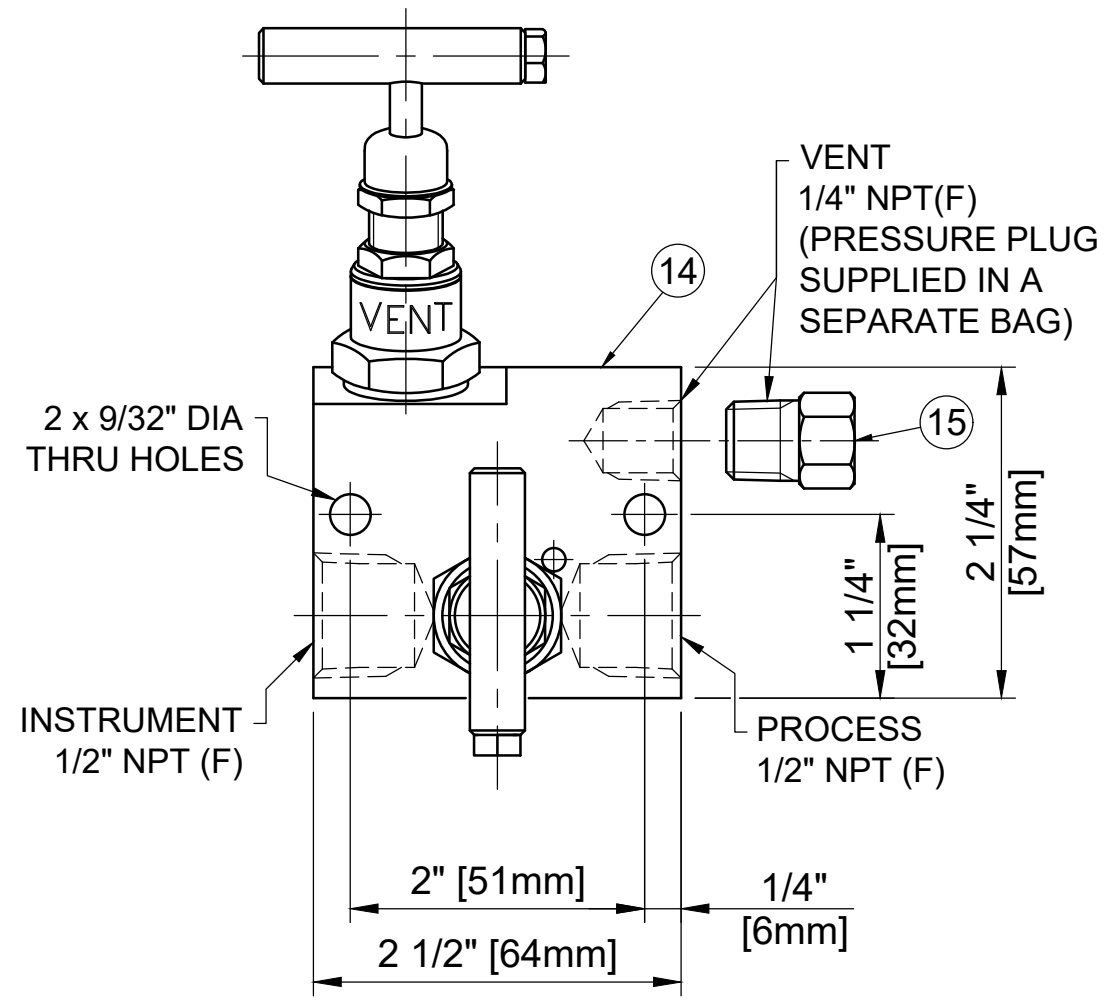

**HEADUNIT DETAIL**

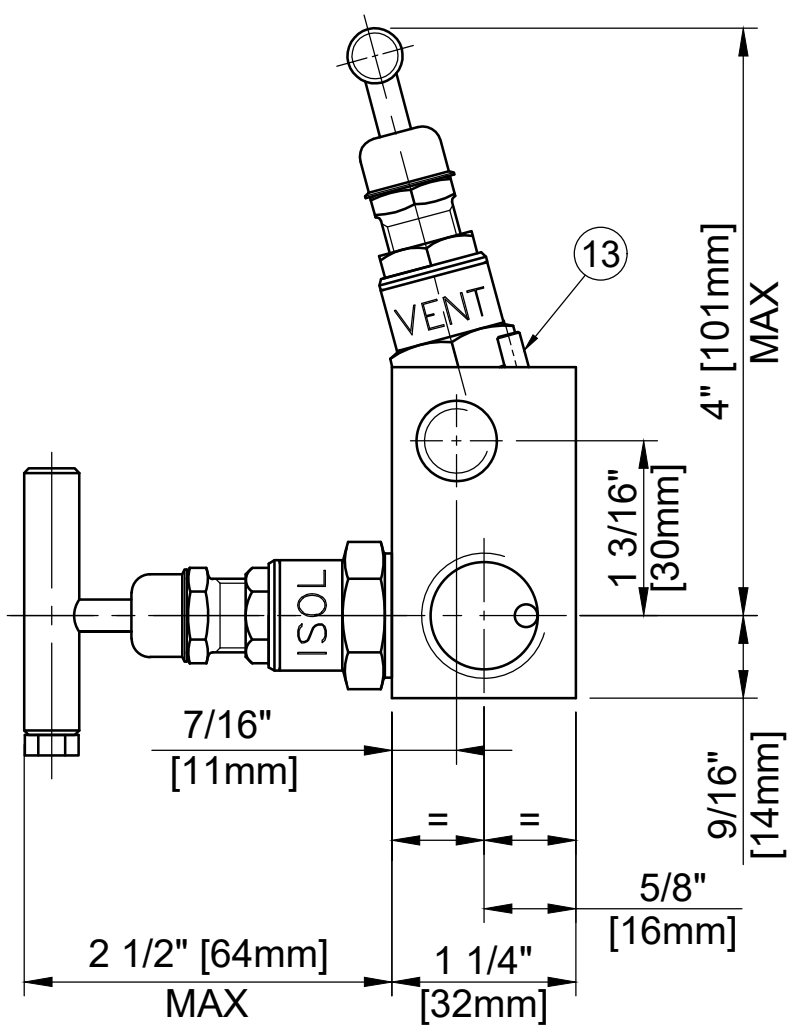
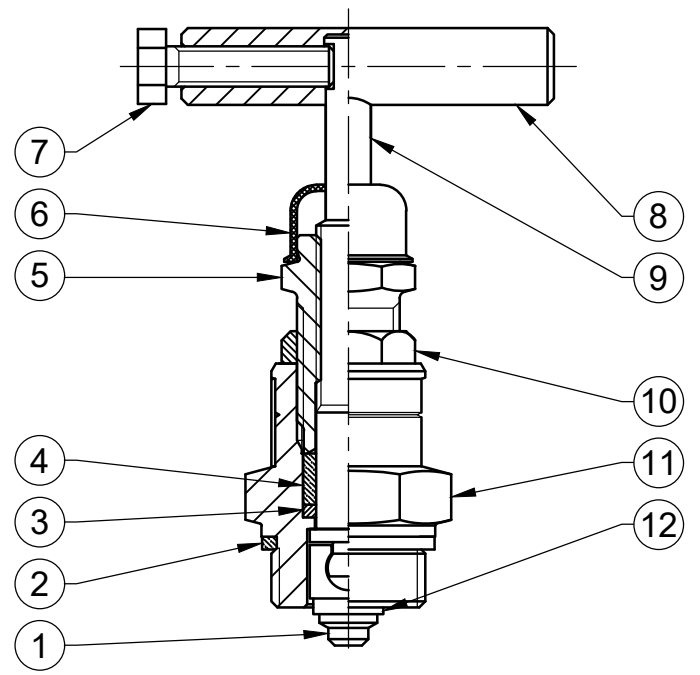

REF No	DESCRIPTION	MATERIAL
		STAINLESS
1	TIP	PEEK
2	BODY SEAL	100% VIRGIN PTFE
3	PISTON RING	316 SS
4	SEAL BUSH	100% VIRGIN PTFE
5	PUSHER	316 SS
6	DUST CAP	LOTREX 2300
7	SCREW	A4 [316] SS
8	TEE BAR	316 SS
9	SPINDLE	ASTM A276 /A479 316
10	LOCKNUT	316 SS
11	SEAL HOUSING	ASTM A276 /A479 316
12	SEAT CARRIER	ASTM A276 /A479 316
13	LOCK PIN	316 SS
14	BODY	ASTM A276 /A479 316
15	PRESSURE PLUG	ASTM A276 /A479 316

**MARKING DETAILS**  
 (MARKING REFERENCE ONLY)



**REMARK**  
 • ADDITIONAL TAG PLATE FOR ADDITIONAL INFO UPON REQUESTED  
 • HCT HEAT CODE TRACEABILITY WILL BE MARKED ON BODY & END FITTINGS

THE INFORMATION CONTAINED IN THIS DRAWING IS THE PROPERTY OF CRANE COMPANY. ANY REPRODUCTION IN PART OR AS A WHOLE WITHOUT THE WRITTEN PERMISSION OF CRANE COMPANY IS PROHIBITED.

APPROVALS	DATE
CREATED ZL	10/10/2023
DRAWN ZL	10/10/2023
APPROVED JQ	17/10/2023
EC NUMBER X	
INITIAL USAGE (REF ONLY) X	
CAD FILE NAME	

REMOVE ALL BURRS, DO NOT SCALE DRAWING, DRILL POINTS STD

BREAK CORNERS 0.005 - 0.010

UNLESS OTHERWISE SPECIFIED, DIMENSIONS ARE IN INCHES

TOLERANCES ARE:  
 .XXX + .005 ANGES .01"  
 .XX + .010 CONCENTRICITY .0015  
 X + .060 MACHINE FINISH 63RMS

<b>CRANE</b>	<b>HOKE</b>
SPARTANBURG, SOUTH CAROLINA 29303	
TITLE GENERAL ARRANGEMENT TYPE G12AF 1/2" FEMALE x FEMALE GAUGE ISOLATE VALVE, PEEK SEAT	
SIZE A3	PAGE CODE -
SCALE N.T.S	ECOM NO XXXXX
DWG NO. A18699	REV D
SHEET 1 OF 1	